

**Models SI**

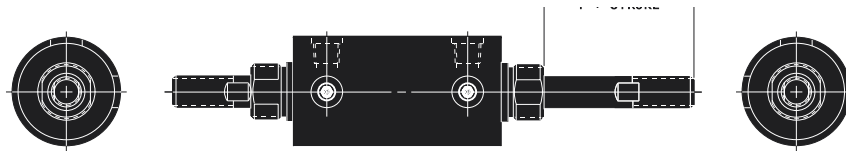

**Models SIDE**

Bore Size	A	B	C	D	E	F	G	H	HH	J	K	L	M*	P	R	S	T
1 <sup>1</sup> / <sub>8</sub>	2 <sup>1</sup> / <sub>16</sub>	1 <sup>5</sup> / <sub>8</sub>	1	5/8	27/64	3/4	1/8	3/4-16	3/4-16	3/8	1/4	7/8	3/8-16	1/8	11/16	1 <sup>3</sup> / <sub>8</sub>	1
1 <sup>1</sup> / <sub>2</sub>	2 <sup>5</sup> / <sub>8</sub>	2 <sup>5</sup> / <sub>16</sub>	1 <sup>1</sup> / <sub>4</sub>	7/8	33/64	1 <sup>1</sup> / <sub>16</sub>	7/32	1 <sup>1</sup> / <sub>16</sub> -18	1-14	1/2	5/16	1 <sup>1</sup> / <sub>4</sub>	1/2-13	1/4	7/8	1 <sup>3</sup> / <sub>4</sub>	1 <sup>7</sup> / <sub>16</sub>
2	2 <sup>5</sup> / <sub>8</sub>	2 <sup>5</sup> / <sub>16</sub>	1 <sup>1</sup> / <sub>4</sub>	7/8	33/64	1 <sup>1</sup> / <sub>16</sub>	7/32	1 <sup>1</sup> / <sub>16</sub> -18	1-14	1/2	5/16	1 <sup>1</sup> / <sub>4</sub>	5/8-11	1/4	7/8	2 <sup>1</sup> / <sub>4</sub>	1 <sup>7</sup> / <sub>16</sub>
2 <sup>1</sup> / <sub>2</sub>	2 <sup>7</sup> / <sub>8</sub>	2 <sup>11</sup> / <sub>16</sub>	2	1	9/16	1 <sup>3</sup> / <sub>8</sub>	11/32	1 <sup>3</sup> / <sub>8</sub> -12	1 <sup>3</sup> / <sub>8</sub> -12	5/8	7/16	1 <sup>1</sup> / <sub>2</sub>	3/4-10	3/8	1 <sup>3</sup> / <sub>8</sub>	2 <sup>3</sup> / <sub>4</sub>	1 <sup>11</sup> / <sub>16</sub>
3	2 <sup>7</sup> / <sub>8</sub>	2 <sup>11</sup> / <sub>16</sub>	2	1	9/16	1 <sup>3</sup> / <sub>8</sub>	11/32	1 <sup>3</sup> / <sub>8</sub> -12	1 <sup>3</sup> / <sub>8</sub> -12	5/8	7/16	1 <sup>1</sup> / <sub>2</sub>	3/4-10	3/8	1 <sup>3</sup> / <sub>8</sub>	3 <sup>1</sup> / <sub>4</sub>	1 <sup>11</sup> / <sub>16</sub>

\*Thread size and rod diameter.

Note: Dimensions that do not appear remain the same (according to bore size) as on the Models SI drawing.

See Application Information for sensors and magnetic switch options, mounting accessories, special options, and ordering information.