

Models F/O/OLF

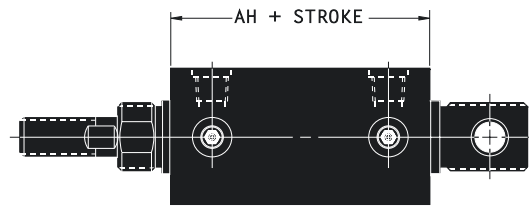

Models H/D

DIMENSION REFERENCE	CYLINDER BORE						DIMENSION REFERENCE	CYLINDER BORE							
	1 ¹ / ₈	1 ¹ / ₂	2	2 ¹ / ₂	3 ¹ / ₄	4		1 ¹ / ₈	1 ¹ / ₂	2	2 ¹ / ₂	3 ¹ / ₄	4		
A	2 ²⁵ / ₃₂	3 ⁵ / ₁₆	3 ⁵ / ₁₆	3 ⁵ / ₁₆	4 ¹¹ / ₁₆	4 ¹¹ / ₁₆	R	1 ¹¹ / ₁₆	7 ⁷ / ₈	1	1	1	1		
B	2 ¹ / ₈	2 ¹ / ₂	2 ¹ / ₂	2 ¹ / ₂	3 ¹⁹ / ₃₂	3 ¹⁹ / ₃₂	S	1 ³ / ₈	1 ³ / ₄	2 ¹ / ₄	2 ³ / ₄	3 ¹ / ₂	4 ¹ / ₄		
C	1 ¹¹ / ₁₆	1 ¹ / ₄	1 ⁵ / ₈	1 ⁵ / ₈	1 ¹¹ / ₁₆	1 ¹¹ / ₁₆	T	1 ¹ / ₂	1 ⁵ / ₈	1 ⁵ / ₈	1 ⁵ / ₈	2 ³ / ₈	2 ³ / ₈		
D	5 ⁵ / ₈	7 ⁷ / ₈	7 ⁷ / ₈	7 ⁷ / ₈	1 ⁷ / ₃₂	1 ⁷ / ₃₂	AH	3 ²⁵ / ₃₂	4 ⁵ / ₁₆	4 ⁵ / ₁₆	4 ⁵ / ₁₆	5 ¹¹ / ₁₆	5 ¹¹ / ₁₆		
E	1 ¹⁹ / ₃₂	1 ¹¹ / ₁₆	1 ¹¹ / ₁₆	1 ¹¹ / ₁₆	3 ³¹ / ₃₂	3 ³¹ / ₃₂	UC	1 ¹ / ₂	1 ¹ / ₂	1 ¹ / ₂	1 ¹ / ₂	1 ¹⁵ / ₁₆	1 ¹⁵ / ₁₆		
F	1.062	1.187	1.187	1.187	1.687	1.687	UT	-	3 ³ / ₄	3 ³ / ₄	3 ³ / ₄	1 ¹ / ₈	1 ¹ / ₈		
G	1 ¹ / ₈	5 ⁵ / ₃₂	5 ⁵ / ₃₂	5 ⁵ / ₃₂	5 ⁵ / ₃₂	5 ⁵ / ₃₂	AX DIMENSION CHART INCLUDING STROKE LENGTHS								
H	1-14	1 ¹ / ₈ -12	1 ¹ / ₈ -12	1 ¹ / ₈ -12	1 ⁵ / ₈ -12	1 ⁵ / ₈ -12	CYLINDER BORE SIZE	STROKE LENGTHS							
J	1 ¹ / ₂	1 ¹ / ₂	1 ¹ / ₂	1 ¹ / ₂	3 ³ / ₄	3 ³ / ₄		1" or Less	Over 1" to 1 ¹ / ₂ "	Over 1 ¹ / ₂ " to 2 ¹ / ₂ "	Over 2 ¹ / ₂ " to 3"	Over 3" to 3 ¹ / ₂ "	Over 3 ¹ / ₂ " to 4 ¹ / ₂ "	Over 4 ¹ / ₂ " to 5 ¹ / ₂ "	Over 5 ¹ / ₂ " to 6"
K	5 ⁵ / ₁₆	5 ⁵ / ₁₆	7 ⁷ / ₁₆	7 ⁷ / ₁₆	1 ¹ / ₂	1 ¹ / ₂	1 ¹ / ₈	6 ²⁵ / ₃₂	7 ²⁵ / ₃₂	8 ²⁵ / ₃₂	9 ²⁵ / ₃₂	10 ²⁵ / ₃₂	11 ²⁵ / ₃₂	13 ²⁵ / ₃₂	15 ²⁵ / ₃₂
L	1 ¹ / ₈	1 ¹ / ₄	1 ¹ / ₄	1 ¹ / ₄	1 ⁷ / ₈	1 ⁷ / ₈	1 ¹ / ₂ , 2, 2 ¹ / ₂	7 ⁵ / ₁₆	8 ⁵ / ₁₆	9 ⁵ / ₁₆	10 ⁵ / ₁₆	11 ⁵ / ₁₆	12 ⁵ / ₁₆	14 ⁵ / ₁₆	16 ⁵ / ₁₆
M*	1 ¹ / ₂ -20	5 ⁵ / ₈ -18	5 ⁵ / ₈ -18	5 ⁵ / ₈ -18	1-14	1-14	3 ³ / ₄ , 4	8 ¹¹ / ₁₆	9 ¹¹ / ₁₆	10 ¹¹ / ₁₆	11 ¹¹ / ₁₆	12 ¹¹ / ₁₆	13 ¹¹ / ₁₆	15 ¹¹ / ₁₆	17 ¹¹ / ₁₆
P-NPTF	1 ¹ / ₈	1 ¹ / ₄	1 ¹ / ₄	1 ¹ / ₄	1 ¹ / ₂	1 ¹ / ₂									

*Thread size and rod diameter.

Note: Dimensions not shown remain the same (according to bore size) as on the Models F/O/OLF drawing with the following exceptions: Models HDE, DDE, HCC and DCC use AH dimension in place of A dimension and Models HSR and DSR add 1" to all AX dimensions. See Application Information for special options.